



Drainage Work Order Request For Repair

Hardin County

Date: 6/3/2020

Work Order #: WO00000295

Drainage District: DDs\DD 121 (51136)

Sec-Twp-Rge: 30-86-20 **Qtr Sec:** _____

Location/GIS: 86-20-30-400-003

Requested By: Tom Gilmore

Contact Phone: (515) 450-1942

Contact Email: _____

Landowner (if different): George C Fagg Heirs

Description: DD 121 - Tom Gilmore reports blow out/ plugged tile and water running across the field on parcel #862030400003.

Repair labor, materials and equipment _____

Repaired By: _____ **Date:** _____

Please reference work order # and send statement for services to: Hardin County Auditor's Office
Attn: Drainage Clerk
1215 Edgington Ave, Suite 1
Eldora, IA 50627
Phone (641) 939-8111
Fax (641) 939-8245

For Office Use Only

Approved: _____ **Date:** _____

Drainage District:

#121

Investigation/Repair Summary:

- Tenant in the SW¼ SE¼ Section 30, Township 86 North Range 20 West reported a blowout/sinkhole, with the tile plugged, and water flowing overland as a result.
- Visual observation found a wet area on the north fenceline, multiple wet areas in the grass swale, a blowout/sinkhole, and water running overland to the downstream of the observed blowout/sinkhole. Also found exposed tile, multiple pieces of broken tile and in the in the field, and large rocks and remnants of trees that had been removed just downstream of the blowout/sinkhole.

Contractor Time and Materials (spent while CGA was on-site):

None recorded as only visual observation was performed.

Additional Actions Recommended:

Due to the lack of soil cover over the tile, broken pieces of tile found in the field, and recently cut trees, CGA recommends locating and CCTV inspecting the tile in both directions from the blowout/sinkhole as the observed issue may be due to a larger-scale deterioration of the Main tile's physical condition.



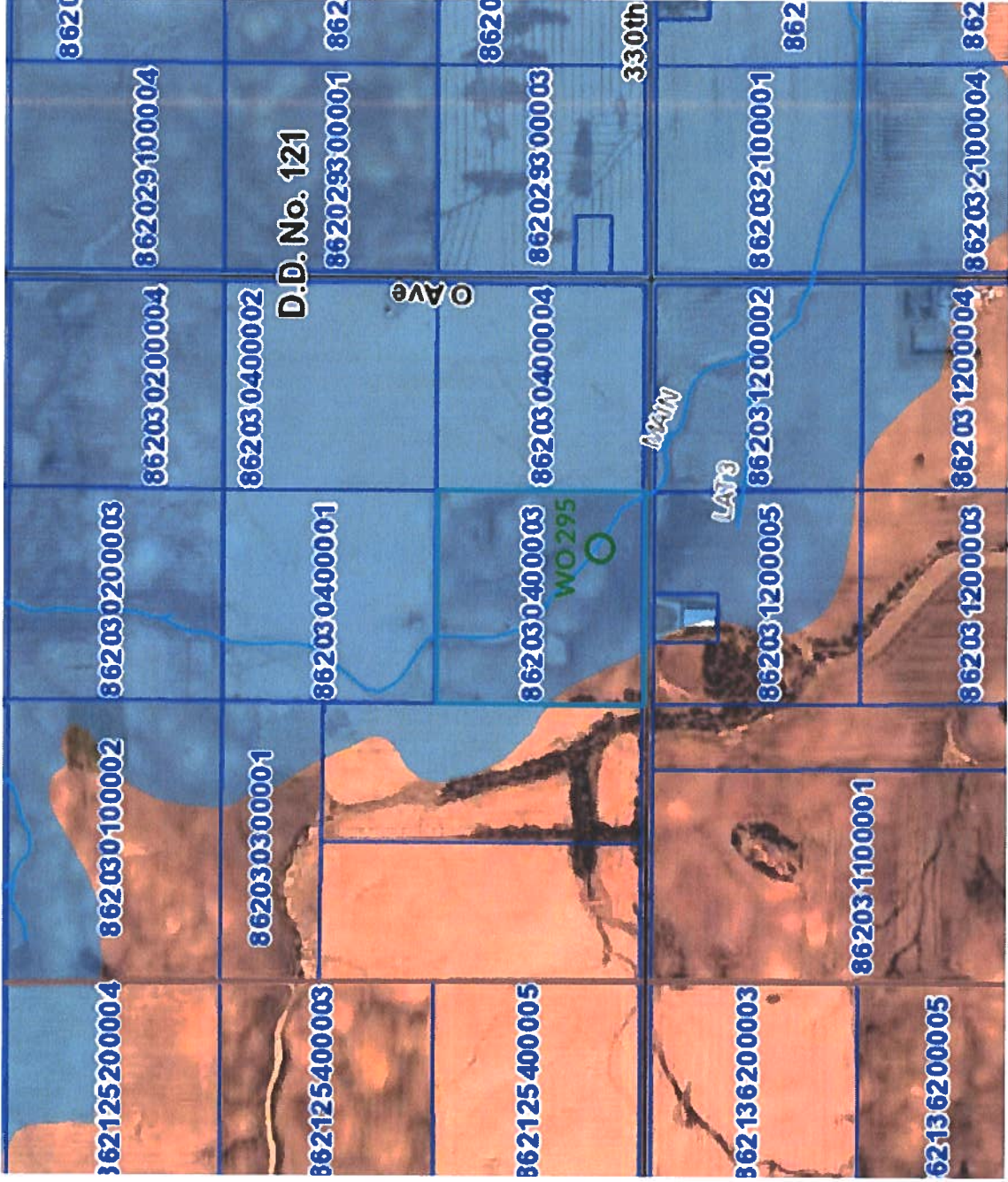

8620

862125200004

862030100002

862030200003

862030200004

862029100004

8620

862125400003

862030300001

862030400002

D.D. No. 121

862029300001

8620

862125400005

862030400004

862029300003

8620

862136200003

862031200005

862031200002

862032100001

8620

62136200005

862031200003

862031200004

862032100004

8620

CONSTRUCTION ENGINEERING
OBSERVATION REPORT

DATE:

6/12/20

PROJECT NUMBER:

6934.1

DAYS OF WEEK:

S M T W T F S

COUNTY, ROUTE, ROAD:

DD 121 HARDIN - MARSHALL Co.

SHEET NO.

1 OF 1

LOCATION:

HARDIN Co. W.O. # 295

DESCRIPTION OF WORK AND MATERIAL USED FOR EACH OPERATION, INCLUDING CONTRACTOR/SUB NAME, ITEM NO. AND LOCATION

Sunny, Calm, 80°, dry Conditions

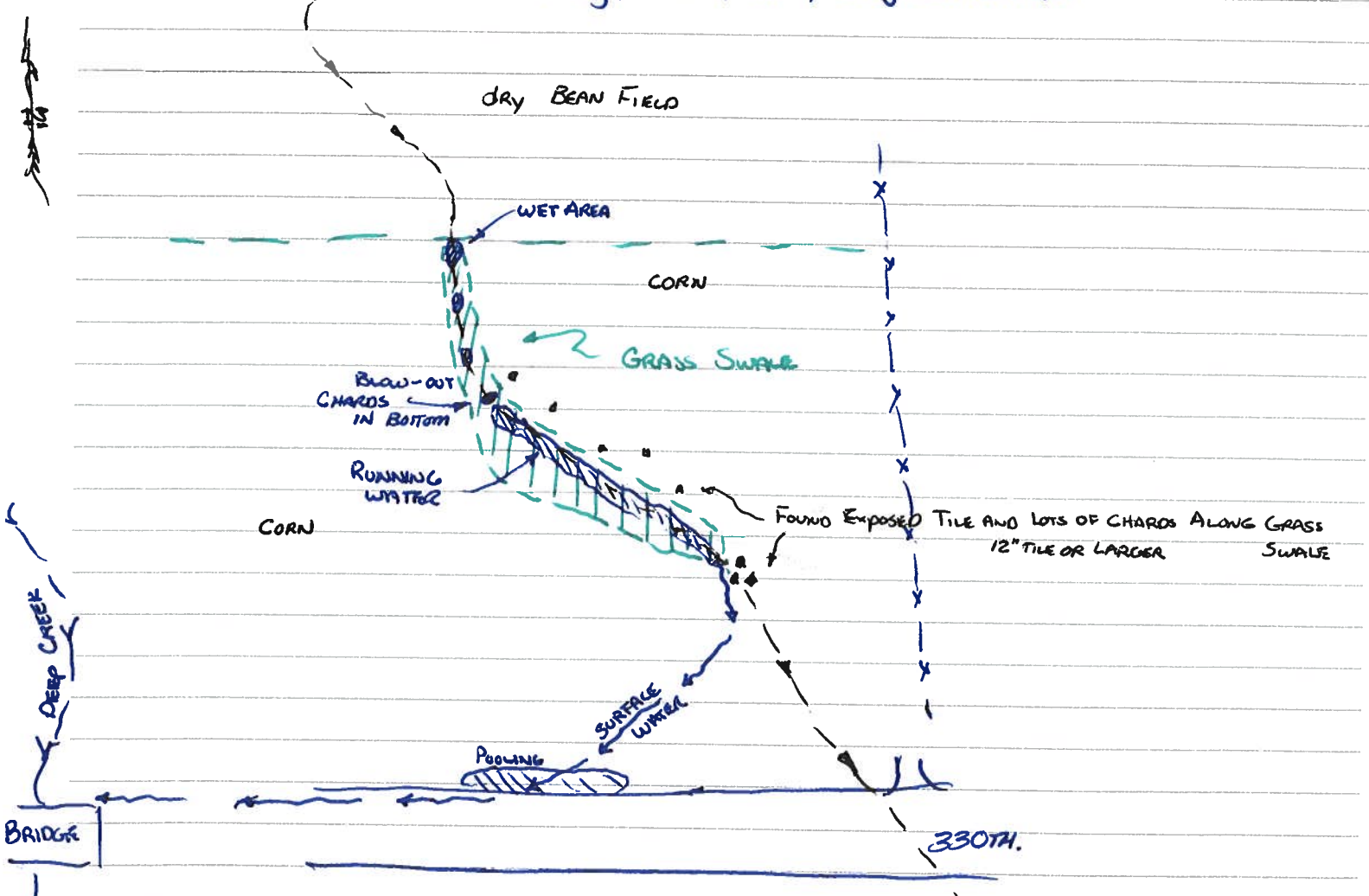

Parked @ 1/4 1/4 cor, WALKED TILL ROUTE FOLLOWING CHANOS IN FIELD 12" + CLAY. FOUND NOISY WATER RUNNING OUT OF GRASS SWALE TO N. SIDE OF 40 ACRES. IT LOOKS LIKE TILE IS VERY SHALLOW OR REMOVED IN SWALE AREA. SOME WATER IN SWALE IS 2' DEEP. I HAVE NO IDEA WHY TILE DOESN'T RUN TO CREEK

I Certify that the work described in this report was incorporated into this contract unless otherwise noted.

Observer's Signature: [Signature] Date Prepared: 6/12/20

Reviewed by: _____ Engineer _____ Date Reviewed: _____

LOOKING NW ON TILE ROUTE



LOOKING SE FROM TIRE CHAINS ON MAIN ROUTE



Exposed TILE CHARDS @ SE COR. OF GRASS SWALE



START OF GRASS SWALE



WATER RUNNING IN 2' DEEP TRENCH IN SWALE



TREES CUT DOWN LAST YEAR



TREES JUST DOWNSTREAM FROM Blow-out



BLOW-OUT, CAN HEAR WATER

